

OPTIVALVE PLUS™ GAS VALVE FLANGED END F4

DN 80 - DN 300

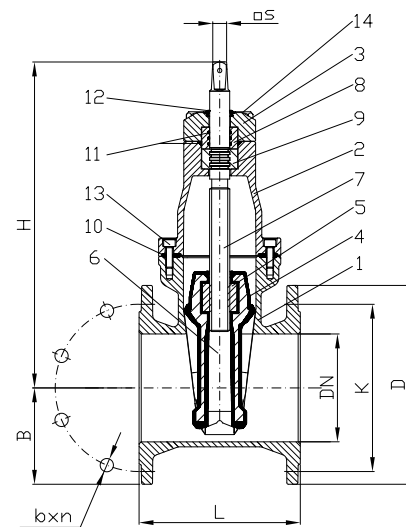

No	Part Name	Material
1	Body	Ductile Iron EN-GJS-500-7
2	Bonnet	Ductile Iron EN-GJS-500-7
3	Gland Housing	Ductile Iron EN-GJS-500-7
4	Wedge	D.I., NBR encapsulated EN-GJS-400-18/ EN-GJS-500-7
5	Wedge Nut	Aluminum Bronze
6	Guide Shoe	Plastic POM
7	Stem	Stainless Steel X20Cr13 / 1.4021 / 420
8	Gland Blush	Aluminum Bronze
9	Support Bush	v Bronze
10	Bonnet Gasket	Elastomer NBR
11	O-ring Seal	Elastomer NBR
12	Dust Seal	Elastomer NBR
13	Bonnet Screws	Stainless Steel A2-70
14	Housing Bolts	Stainless Steel A2-70



Dimension:

DN	80	100	125	150	200	250	300	400
EPOXY POWDER COATING								
PN16	BG0848	BG1048	BG1268	BG1548	BG2048	BG2548	BG3048	BG4028
PN10					BG2047	BG2547	BG3047	BG4038
EPOXY POWDER COATED WITH A POLYURETHANE (PUR) OVERSPRAY, BLACK								
PN16	BG0845	BG1045	BG1245	BG1545	BG2045	BG2545	BG3045	N.Z.
PN10					BG2044	BG2544	BG3044	N.Z.
L	180	190	200	210	230	250	270	310
H	315	349	465	454	556	646	727	1010
B	95	102	120	134	165	196	225	300
K PN16 / PN10	160	180	210	240	295	355 / 350	410 / 400	525 / 515
b x n PN16 / PN10	19x8	19x8	19x8	23x8	23x12 / 23x8	27x12 / 23x12	27x12 / 23x12	525 / 515
D	200	220	250	285	340	405	460	580
Stem Top Square □S	17	19	19	19	24	27	27	29
Turns to open/close	7 1/2	9 1/4	13 3/4	13 3/4	18	21 3/4	26 1/3	34 1/2
Closing Torque [Nm]	70±10	80±10	100±20	100±20	130±20	180±20	200±20	250±20
Weight [kg]	20,3	23,3	41,2	43	68,4	89,3	136	267

Notes:

- All diameters available with PN10 or PN16 flanges.
- Right-hand closing.

RESILIENT SEATED GATE VALVE OPTIVALVE PLUS™ FLANGED END F4

DN 400



No	Part Name	Material
1	Body	Ductile Iron EN-GJS-500-7
2	Bonnet	Ductile Iron EN-GJS-500-7
3	Gland Housing	Ductile Iron EN-GJS-500-7
4	Wedge	D.I., NBR encapsulated EN-GJS-400-18/ EN-GJS-500-7
5	Wedge Nut	Aluminium Bronze
6	Stem	Stainless Steel X20Cr13 / 1.4021 / 420
7	Gland Bush	H.T. dezincification resistant Brass
8	Rolling Bearing	Component
19	Bonnet Gasket	Elastomer NBR
10	O-ring Seal	Elastomer NBR
11	Gasket	Elastomer NBR
12	Dust Seal	Elastomer NBR
13	Bonnet Screws	Stainless Steel A2-70
14	Housing Bolts	Stainless Steel A2-70

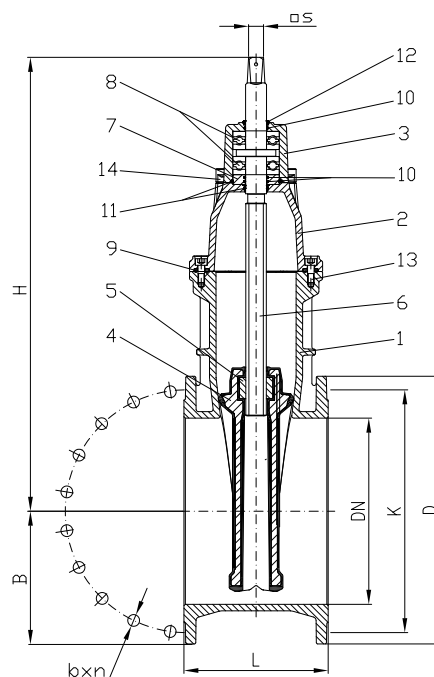

Dimension:

DN	400
EPOXY POWDER COATING	
PN16	BG4028
PN10	BG4038
POWDER COATING WITH EPOXY PAINT AND ADDITIONAL LAYER OF POLYURETHANE (PUR) - BLACK	
PN16	BG4074
PN10	BG4076
L	310
H	975
B	285
K PN16 / PN10	525 / 515
b x n PN16 / PN10	31×16 / 28×16
D	580
Stem Top Square □S	32
Turns to open/close	34 ½
Weight [kg]	283

Notes:

- All diameters available with PN10 or PN16 flanges
- Clock-wise to close