

OPTIVALVE™ GAS VALVE FLANGED END F5

DN 40 - DN 300

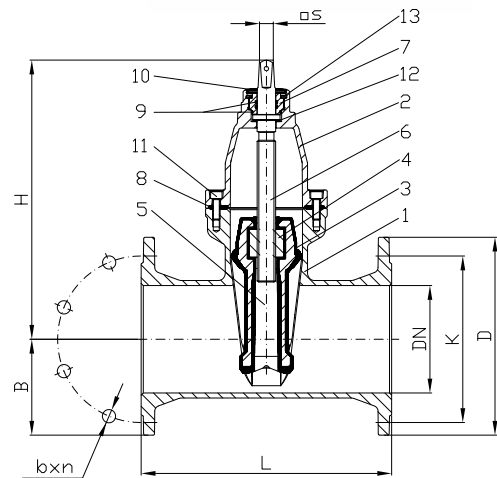

No	Part Name	Material
1	Body	Ductile Iron EN-GJS-500-7
2	Bonnet	Ductile Iron EN-GJS-500-7
3	Wedge	D.I., NBR encapsulated EN-GJS-400-18/ EN-GJS-500-7
4	Wedge Nut	Brass
5	Guide Shoe	Plastic POM
6	Stem	Stainless Steel X20Cr13 / 1.4021 / 420
7	Gland Blush	Brass
8	Bonnet Gasket	Elastomer NBR
9	O-ring Seal	Elastomer NBR
10	Dust Seal	Elastomer NBR
11	Bonnet Screws	Stainless Steel A2-70
12	Bottom Washer	Plastic POM
13	Acetal Circlip	Steel Ring



Dimension:

DN	40	50	65	80	100	125	150	200	250	300
EPOXY POWDER COATING										
PN16	AG0409	AG0511	AG6522	AG0829	AG1029	AG1265	AG1522	AG2039	AG2539	AG3039
PN10								AG2029	AG2529	AG3029
BLACK EPOXY POWDER COATING AND POLYURETHANE (PUR) TOPCOAT										
PN16	AG0416	AG0516	AG6516	AG0816	AG1016	AG1216	AG1516	AG2076	AG2576	AG3076
PN10								AG2017	AG2517	AG3017
L	240	250	270	280	300	325	350	400	450	500
H	209	250	246	265	299	402	390	490	562	642
B	70	75	85	95	102	120	134	165	196	225
K PN16 / PN10	110	125	145	160	180	210	240	295	355 / 350	410 / 400
b x n PN16 / PN10	19×4	19×4	19×4	19×8	19×8	19×8	23×8	23×12 / 23×8	27×12 / 23×12	27×12 / 23×12
D	150	165	185	200	220	250	285	340	405	460
Stem Top Square □S	14	14	17	17	19	19	19	24	27	27
Turns to open/close	6 ¼	9 ¾	9 ¾	11 ½	14 ¼	20 ¼	20 ¼	18	26 ⅓	26 ⅓
Closing Torque [Nm]	40±10	50±10	60±10	70±10	80±10	100±20	100±20	130±20	180±20	200±20
Weight [kg]	12,5	14,7	16,3	18,8	21,9	38,5	40,7	66,5	93,2	145

Specifications:

- Available in all sizes with PN10 or PN16 flanges.
- Clockwise closing.